

# ART-IN-SITE

## Recent Projects by Chandra Cerrito / Art Advisors

### Medical Office Building, Berkeley

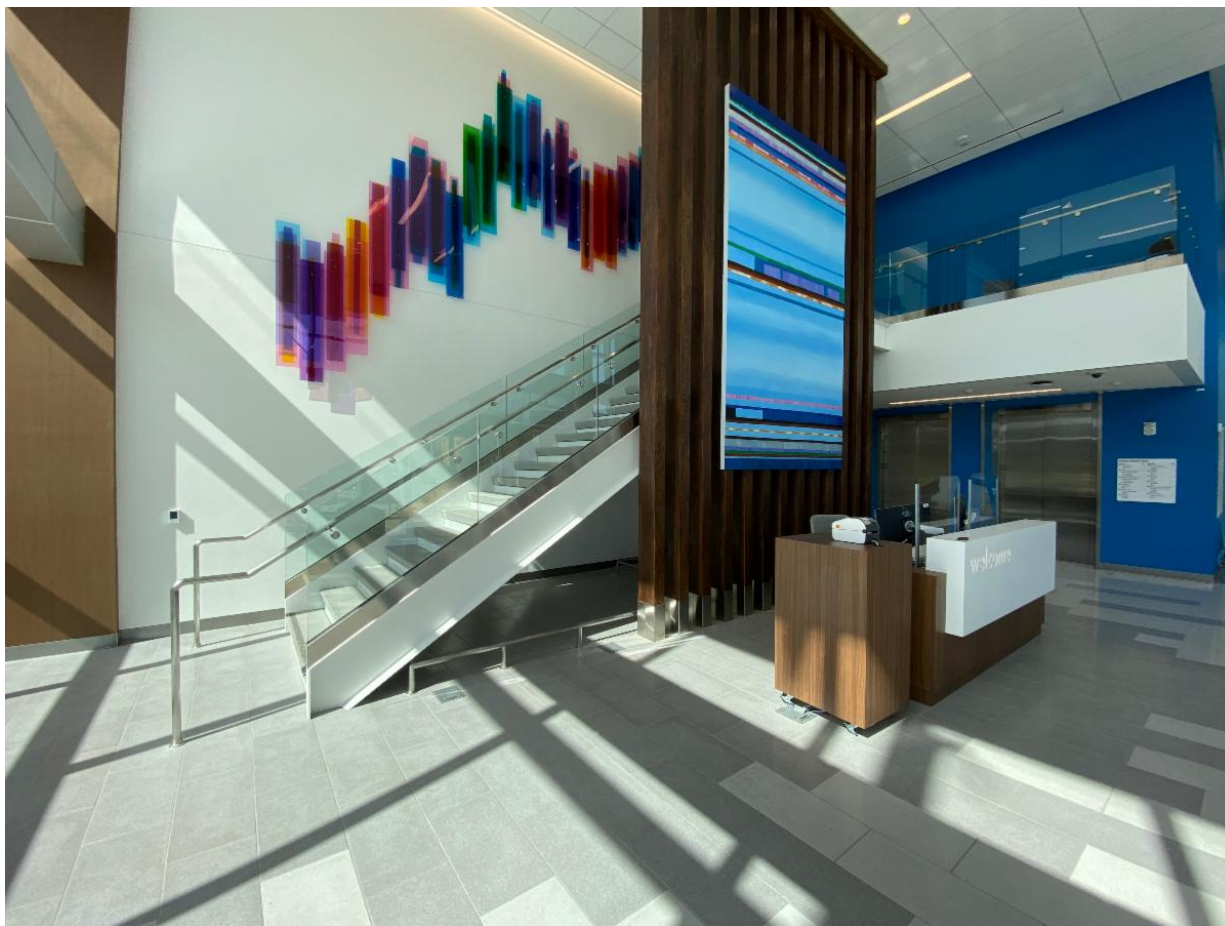

*Raining Down Color* by Melissa Borrell and *Re:Configuration* by Maya Kabat

Chandra Cerrito / Art Advisors received request from a repeat national healthcare client and architect team looking to develop a comprehensive art program for their new three-story medical office building in Berkeley, CA. The client was looking to reflect the “story” of the city of Berkeley, purchasing artworks by artists working in, or with strong ties to Berkeley and the East Bay.

Multiple artworks reflect the “feel” of the city through themes of environmentalism, higher

education, and the city's architecture. Artworks were to be uplifting as well as calming, while incorporating a full-spectrum of color.

A twelve foot oil painting at the Welcome Lobby, with bright, horizontal lines and ombre blues (her largest commission to date) by Maya Kabat entitled *Re:Configuration* calls upon the calming, healing power of water.

At the stairs between the welcome lobby and second floor lobby is an acrylic installation by former Bay Area artist Melissa Borrell, entitled *Raining Down Color*. The piece picks up light from the lobby's two-story windows, and its dynamic form invites users up the stairs to the second level of the building.

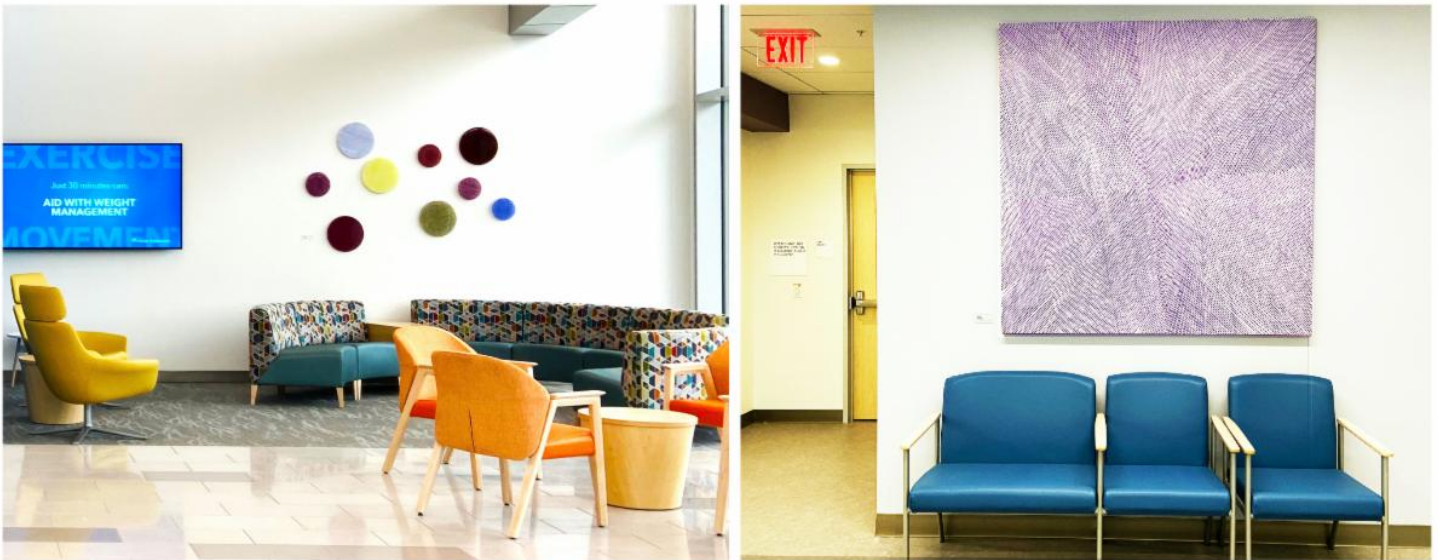

Works from left to right: *Bloom* and *Lilac Aura* by Mel Prest

An installation of glass discs by painter Mel Prest entitled *Bloom* calls upon the artist's vocabulary of minimal, linear forms whose colors are based on flowers found growing in the Bay Area. The series was created during the artist's residency at Bullseye Glass in neighboring Emeryville, her first exploration with this new medium. Upstairs in the pharmacy, her painting *Lilac Aura* mirrors the linear patterns of the glass, in the artist's more familiar media, acrylic on panel, creating a dynamic conversation between the two bodies of work.



Works from left to right: *Wall Gardens* and *Tree Lace* by Melissa Borrell

Two additional powder-coated metal installations of Melissa Borrell's are also found upstairs. These dynamic, dimensional works aid patient way-finding, creating visual interest for wait areas as well as demarcating public space from department interiors.



Works from left to right: *No Time Like Now* and *Berkeley Hillsides* by Lisa Levine

Large-scale photographic composite prints by Lisa Levine pull together the architectural styles of Berkeley, and reflect the myriad of cultures and faces of local residents.





Works from left to right: *3.30.19.6979* by Dale Kistemaker and *Chroma Purple* by Judith Selby-Lang and Richard Lang

The collection also includes “beach plastic” photographs by celebrated Bay Area artists and environmentalists Judith Selby-Lang and Richard Lang, and a print installation of books by former Bay Area photographer Dale Kistemaker.

Chandra Cerrito / Art Advisors | 626 Costa Drive, Napa, CA 94558

[Unsubscribe {recipient's email}](#)

[Update Profile](#) | [Constant Contact Data Notice](#)

Sent by [ccc@chandraceritto.com](mailto:ccc@chandraceritto.com) powered by



Try email marketing for free today!